

Features:

- ☒ 1-phase and 3-phase line reactors
- ☒ produced according to VDE 0550/0532
- ☒ insulation class T40E
- ☒ test voltage 2,5kV
- ☒ $U_K = 4\%$
- ☒ vertically mounted on base brackets
- ☒ terminals according to VBG4
- ☒ degree of protection IP00 suitable up to IP20

Line Reactors
K ... , ND ...
CE

Function:

The use of line reactors increases the natural impedance of the connected load. The rate of the current rise is considerably reduced, which dampens the harmonics and thus the system perturbation.

Typical Applications:

- frequency inverters
- power converters
- soft starters

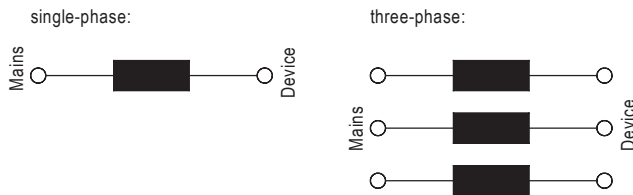

Technical Data	Line reactor/1-phase K ...			
	60-6	66-10	78-16	84-25
Area required in mm	52x50	56x52	66x60	72x65
Type of connection	screw terminals			
for Motor shaft power	-0,37kW	-0,75kW	-1,5kW	2,2kW
Nominal current	6A	10A	16A	25A
Inductance	4,5mH	2,8mH	1,7mH	1,0mH
Order number	23100.06006	23100.06610	23100.07816	23100.08425

Technical Data	Line reactor/3-phase ND ...							
	3-6	3-10	3-16	3-25	3-50	3-75	3-100	3-125
Area required in mm	100x55	125x65	125x75	155x75	155x90	190x110	240x125	240x135
Type of connection	screw terminals							
for Motor shaft power	-1,5kW	-3kW	-5,5kW	7,5kW	-18,5kW	-30kW	37kW	-55kW
Nominal current	6A	10A	16A	25A	50A	75A	100A	125A
Inductance	4,5mH	2,8mH	1,7mH	1,0mH	0,6mH	0,38mH	0,28mH	0,23mH
Order number	22900.00006	22900.00010	22900.00016	22900.00025	22900.00050	22900.00075	22900.00100	22900.00125

Upon request, for motor shaft power exceeding 55kW.

Dimensions:

single-phase:

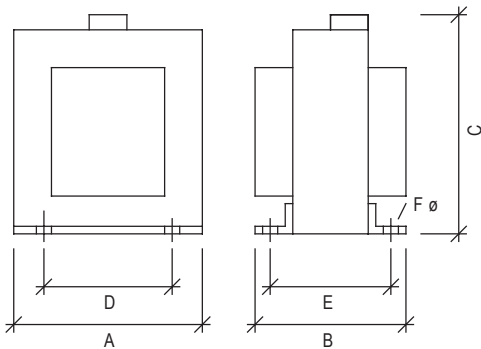

	Dimensions (mm)						Weight (kg)
	A	B	C	D	E	F	
K 60-6	52	50	62	38	36	3,3	0,6
K 66-10	56	52	88	44	38	3,3	0,75
K 78-16	66	60	102	50	46	4,5	1,5
K 84-25	72	65	110	56	49	4,5	1,8

three-phase:

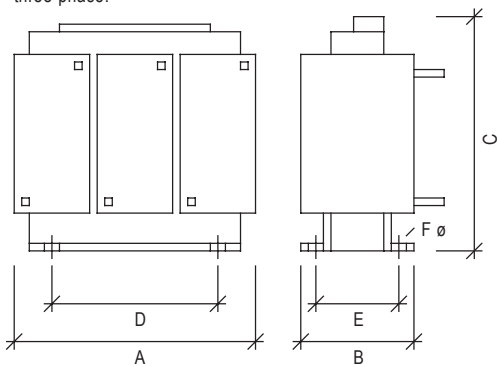

	Dimensions (mm)						Weight (kg)
	A	B	C	D	E	F	
ND 3-6	100	55	115	56	44	4,5	2
ND 3-10	125	65	140	84	45	5,0	2,5
ND 3-16	125	75	140	84	55	5,0	2,8

Connection Diagram:

single-phase:

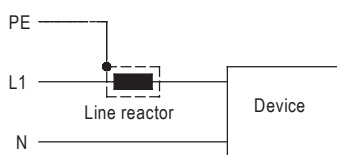

three-phase:

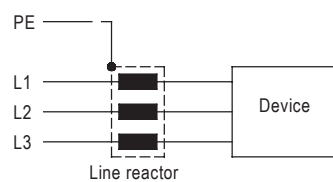
**Installation:**

If it is necessary for interference suppression purposes to connect a mains filter in series before the device to be suppressed, the line reactor has to be installed before the mains filter.